

Joint  
Development  
Control  
Committee  
17 July 2024



**GREATER CAMBRIDGE**  
SHARED PLANNING

# 21/02957/COND27

**Site address:** West Anglia Main Line Land Adjacent to Cambridge Biomedical  
Campus

Page 2

**Proposal:**

Submission of details required by condition 27 (lighting scheme) of Transport and Works Act Order 21/02957/TWA

# Location Plan

Station location

Page 3

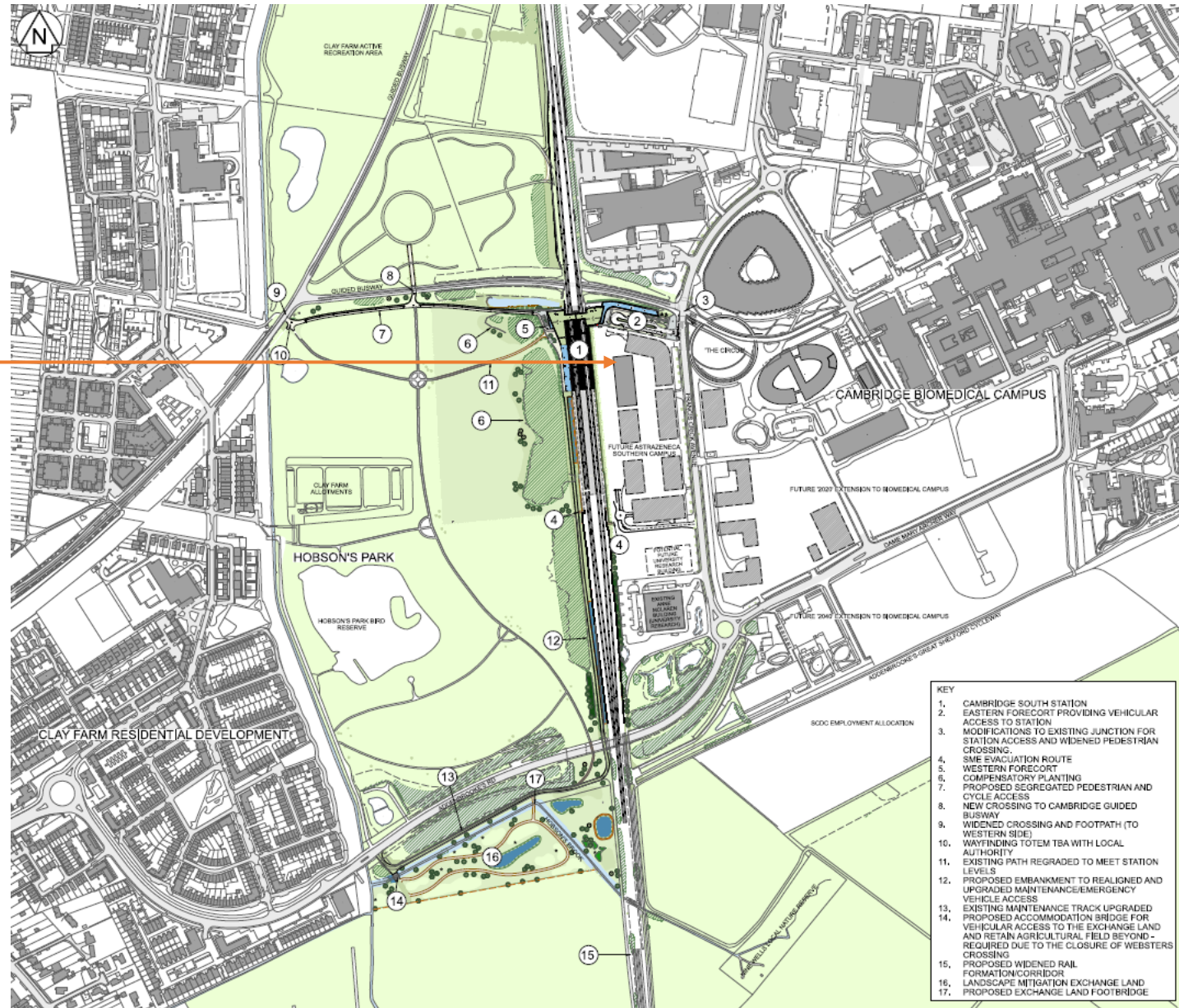

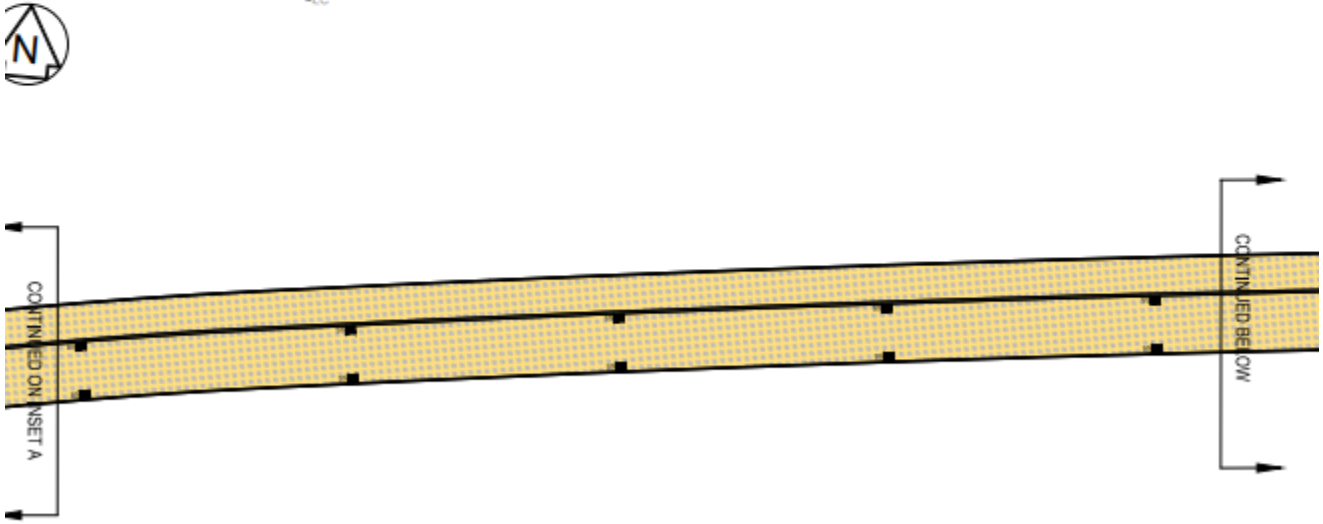
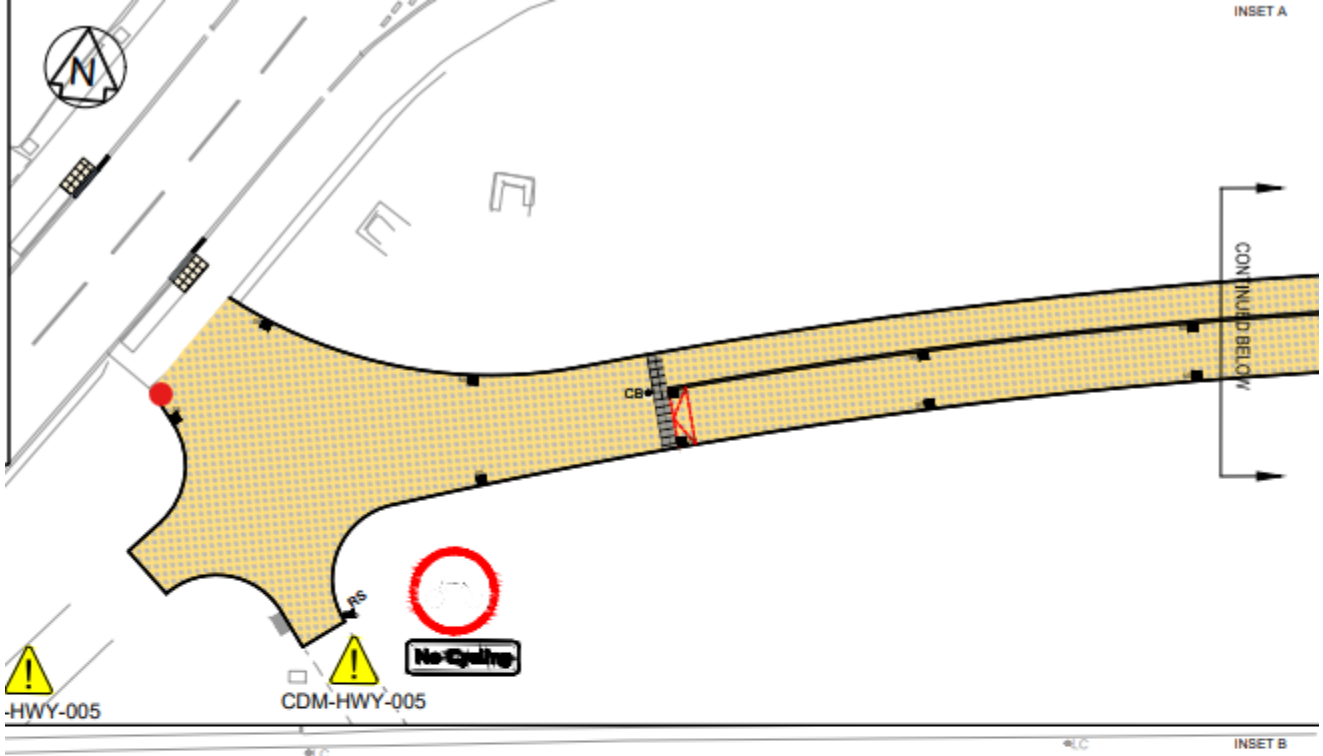



**SAFETY, HEALTH AND ENVIRONMENTAL INFORMATION**

In addition to the hazards/risks normally associated with the types of work detailed on this drawing, note the following:

<b>CONSTRUCTION</b>
POTENTIAL CYCLISTS CONFLICTS ON CYCLE PATH NDN11 - SEE CDM-HWY-006
<b>OPERATIONAL USE</b>
A 60mm DELINEATOR KERB IS LOCATED BETWEEN THE CYCLEWAY AND FOOTWAY ON THE SEGREGATED SECTIONS WITH THE CYCLEWAY BEING 60mm LOWER THAN THE FOOTWAY. WAYFINDING LIGHTING IS PROVIDED IN THE FORM OF SOLAR STUDS ON TOP OF THE KERB. THERE IS POTENTIAL FOR THE KERB UPSTAND AND LOW LEVEL LIGHTING TO CAUSE A TRIP HAZARD.
<b>MAINTENANCE/CLEANING</b>
NONE
<b>DECOMMISSIONING/DEMOLITION</b>
NONE

PROPOSED EMERGENCY VEHICLE AREA AS PER FIRE STRATEGY DOCUMENT 158454-JMS-ZZ-ZZZ-REP-FIR-000001

CONTINUED ON DRAINING No. 158454-JMS-ZZ-ZZZ-DRG-EHW-100003

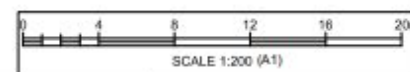

This page is intentionally left blank